



STARHOTELS®

PREMIUM

Du Parc

PARMA

Du Parc

PARMA



Art Nouveau Elegance

The Starhotels Du Parc, an elegant hotel that still retains its original façade and exquisite Art Nouveau interiors, stands in the centre of Parma, beside the lush greenery of Parco Ducale. It welcomes guests in its 169 spacious rooms and suites, provided with every comfort and enriched by refined decorative details.

Du Parc

PARMA



Location

Within easy reach of the station and only 4 kilometres from the Exhibition Centre. A small bridge links it to the magnificent Parco Ducale and the historic centre

Distances

Railway station: Km 0,5

Highway: Km 3

Airport: Giuseppe Verdi Km 5

Fairgrounds: Km 4

Viale Piacenza, 12/c - 43100 Parma - ITALY

T +39 0521 292929 F +39 0521 292828

duparc.pr@starhotels.it

starhotels.com

Du Parc

PARMA

Restaurant & Bar

The Canova restaurant's is a wonderful setting to enjoy local and international dishes, while the neighbouring Aiglon and Parmigianino rooms can host up to 250 guests for banquets and large events.

The elegant Canova bar is the ideal venue for a superb coffee, a light lunch or a cocktail.



Du Parc

PARMA



169 Rooms

- 18 Classic
- 64 Superior
- 67 Deluxe
- 6 Junior Suite
- 8 Junior Suite Deluxe
- 6 Suite

Each of the 169 rooms has its own distinctive style and an attractive touch of Art Nouveau flair created by refined furnishings, sumptuous brocades, tapestries and beautiful fabrics in warm colours.



Du Parc

PARMA



Meetings & Events

Meeting rooms: 10

Capacity (theatre style): 550 max

The hotel offers 10 bright, versatile meeting rooms can host up to 550 participants and are equipped with high-tech conference facilities. A team of professionals is at guests' disposal to handle any type of event with great skill and attention to detail.



Du Parc

PARMA

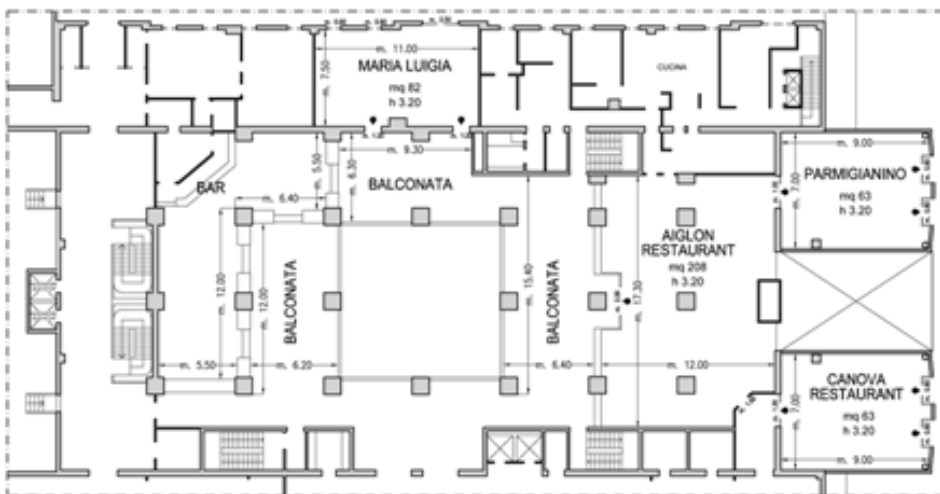

Piano Terra / Ground Floor



Piano -1 / Basement

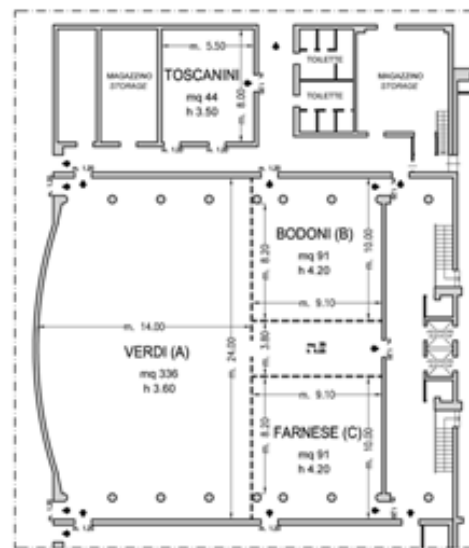

Piano -2 / Floor -2

- ◆ Uscite di sicurezza / Emergency Exits
- Finestre / Windows
- ▤ Paredi mobili / Modular Walls
- Colonne / Columns

Du Parc

PARMA

Meeting rooms	Area mq / ft.	L x W mt. / ft.	Height mt. / ft.	Theatre	Class room	Conference table/ U-shape	Cabaret style^	Cocktail reception	Banquet
Verdi (A)	336 3615,36	14,00x24,00 45,93x78,74	3,6 11,81	300	120	75	108	350	250
Bodoni (B)	91 979,16	10,00x9,10 32,81x29,86	4,2 13,78	70	40	30	24	90	40
Farnese (C)	91 979,16	10,00x9,10 32,81x29,86	4,2 13,78	70	40	30	24	90	40
(A+B+C)	564 6070,82	23,50x24,00 77,10x78,74	3,60-4,20 11,81-13,78	550	250	140	210	500	450
Toscanini	44 473,44	8,00x5,50 26,25x18,04	3,5 11,48	35	14	16	14	-	-
Maria Luigia°	82 882,32	11,00x7,50 36,09x24,61	3,2 10,5	50	25	25	24	50	-
Stendhal°	60 645,83	6,50x9,20 21,33x30,18	2,7 8,86	35	18	18	12	-	-
Rossini°	76 818,05	12,80x6,00 41,99x19,68	2,7 8,86	50	25	22	18	50	-
Puccini°	84 904,16	14,00x6,00 45,93x19,68	2,7 8,86	75	30	30	24	-	-
Donizetti	44 494,96	8,50x5,50 27,89x18,04	2,7 8,86	35	14	16	14	-	-
Mozart	25 269,1	4,90x4,73 16x15	3,4 11	15	-	8	-	-	-
Foyer Congressi	120 1291,2	10,00x12,00 32,81x39,37	-	-	-	-	-	120	-
La Piazzetta	115 1237,84	10,50x11,00 34,44x36,08	-	-	-	-	-	110	-
Aiglon + Parmigianino Canova + Balconate	570 6135,4	22,00x26,00 72,18x85,30	-	-	-	-	500	450	-
Canova Restaurant °	63 677,88	7,00x9,00 22,97x29,53	-	-	-	-	-	-	50
Aiglon room	208 2238,92	17,30x12,00 56,74x39,36	-	-	-	-	-	250	180
Parmigianino	63 677,88	7,00x9,00 22,97x29,53	-	-	-	-	-	-	50

° Daylight

^ Cabaret style: Diameter tables cm 180, up to 6 pax each